

AR 99-

111

Submitted by: Chairman of the Assembly at the
Request of the Mayor
Prepared by: Anchorage Water & Wastewater
Utility
For reading: May 11, 1999

CLERK'S OFFICE
APPROVED

Date: 5-25-99

ANCHORAGE, ALASKA
AR NO. 99-111

**A RESOLUTION APPROVING THE KLUANE TERRACE PHASE II WATER MAIN
EXTENSION AND PROVIDING FOR ASSESSMENT OF BENEFITED
PROPERTIES AT TIME OF SERVICE CONNECTION**

WHEREAS, Alaska State Statute 42.05.385 and AMC 19.90 mandate that when a water line extension will create, or has the potential of creating, any charge or assessment against the adjacent property, the water line extension may not be constructed unless the legislative body of each municipality through which the extension passes has approved the extension.

WHEREAS, the Anchorage Water and Wastewater Utility (AWWU) plans to construct water mains in the Valley Street and Kathy Place rights-of-way between Rangeview Drive and East 10th Avenue, in the Rangeview Avenue right-of-way between Valley Street and Cherry Street, and in the Kluane Drive right-of-way through the *Kluane Terrace Phase II Water Upgrade* project.

WHEREAS, the extension of the water line will specially benefit and provide water service to one (1) property and in doing so, will create potential assessments against it.

NOW THEREFORE, THE ANCHORAGE ASSEMBLY RESOLVES:

Section 1. It is in the best interest of the community that said water main improvement proceed.

Section 2. AWWU shall keep an accurate account of all costs of the water main improvements.

Section 3. After the water main improvements have been completed and the costs of the water line approved, the Mayor shall cause the computation of all applicable assessment charges.

Section 4. At such time as the property cited on the attached assessment roll connects to the water main, the respective pro-rata assessment for the water line shall be levied in accordance with Municipal Codes and the AWWU Water Utility Tariff in effect at the time.

Section 5. A Special Assessment Collection Charge, as authorized in Section 13.04 of the Water Utility Tariff, in effect at the time the assessment is levied, will be charged to those properties identified in this resolution.

Section 6. This resolution shall take effect immediately upon passage and approval by the Anchorage Municipal Assembly.

PASSED AND APPROVED by the Anchorage Municipal Assembly this 25th day of May, 1999.

Chairman

ATTEST



Municipal Clerk



Parcel located in S.M., Alaska

107

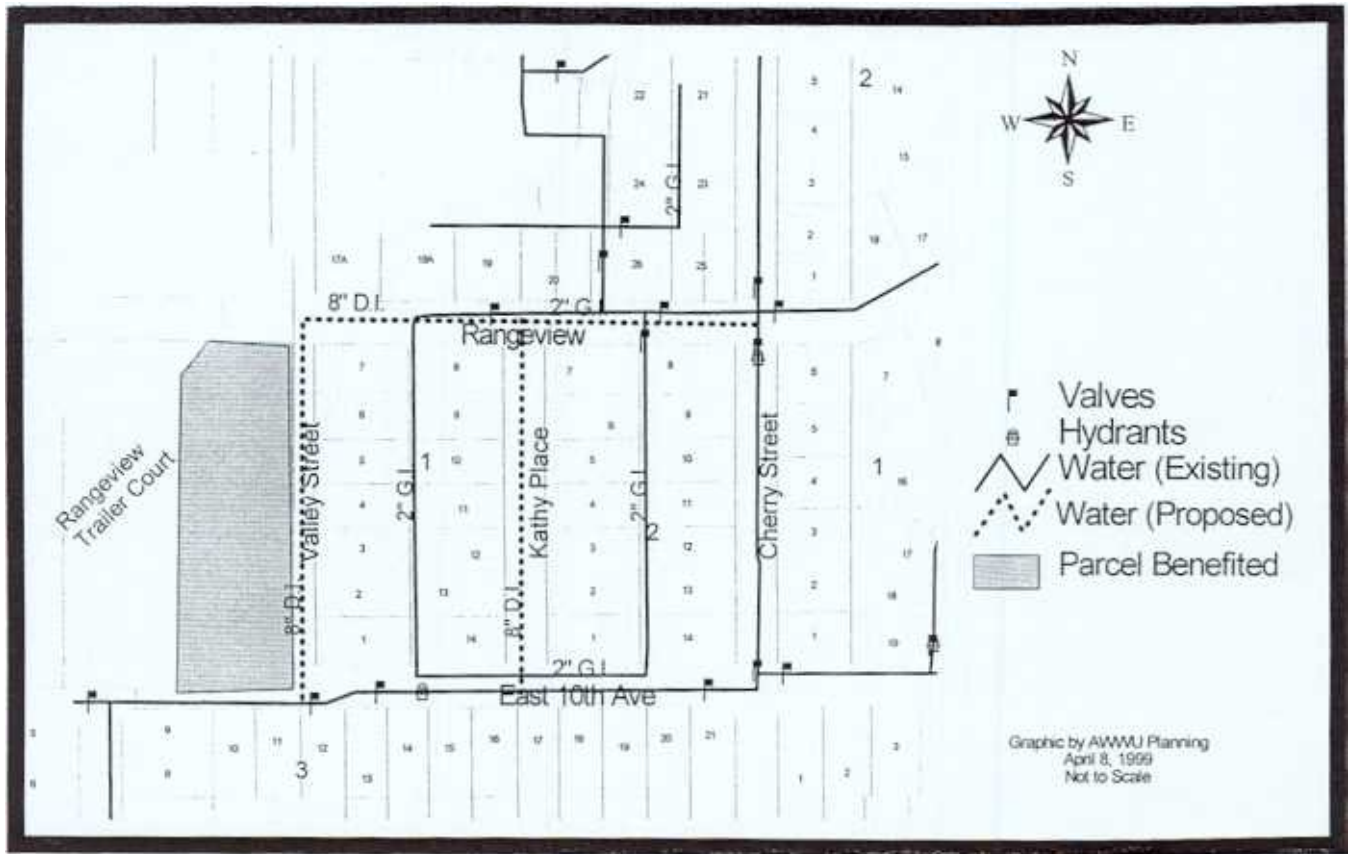
Item	Tax Code	Subdivision	Grid	Lot	Total Area	Ass'ble Area	Estimated Rate	Estimated Ass'm't
1	006-111-18	Section 13,T13N R3W	1341	Portion Lot 4 *	80,600	73,877	\$0.90	\$66,489.30



043957 24-
ANCHORAGE
RECORDING DISTRICT

1999 JL -9 AM 11:33
REQUESTED BY
MOA

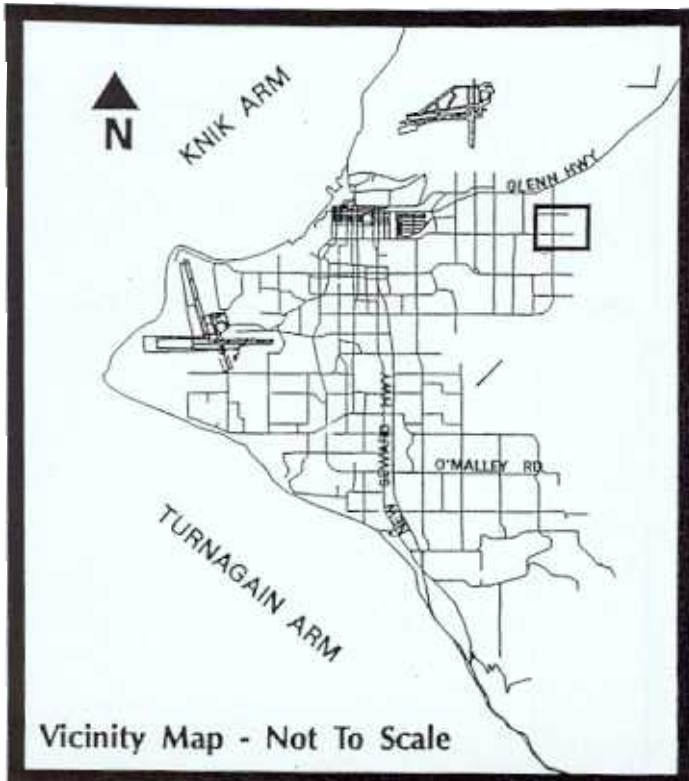

KLUANE TERRACE PHASE II WATER UPGRADE

Anchorage Water & Wastewater Utility



**Kluane Terrace, Phase II
Water Main
Estimated Assessment Roll**

Item	Tax Code	Subdivision	Grid	Lot	Total Area	Ass'ble Area	Estimated Rate	Estimated Ass'm't	Name
1	006-111-18	Section 13,T13N R3W	1341	Portion Lot 4 *	80,600	73,877	\$0.90	\$66,489.30	Rangeview Tra Tel Inc and Rangeview Annex

* SE1/4,NE1/4,SE1/4,NW1/4,SE1/4